

309 Flat Lid Installation Guide

RECESSED TOPGUIDE SYSTEMS

Diagram & Parts 2

Installing the 309 Flat Lid 3-4



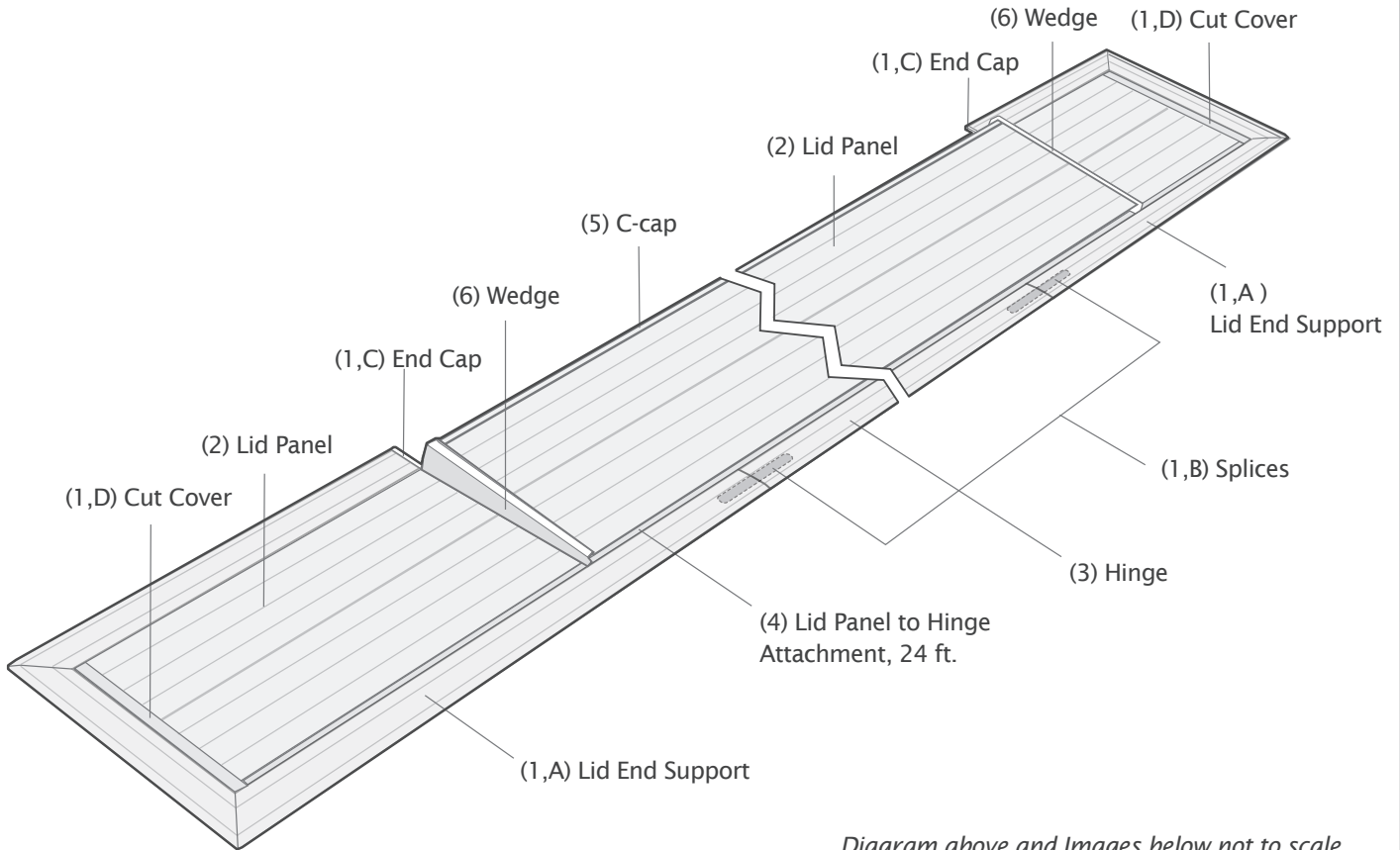
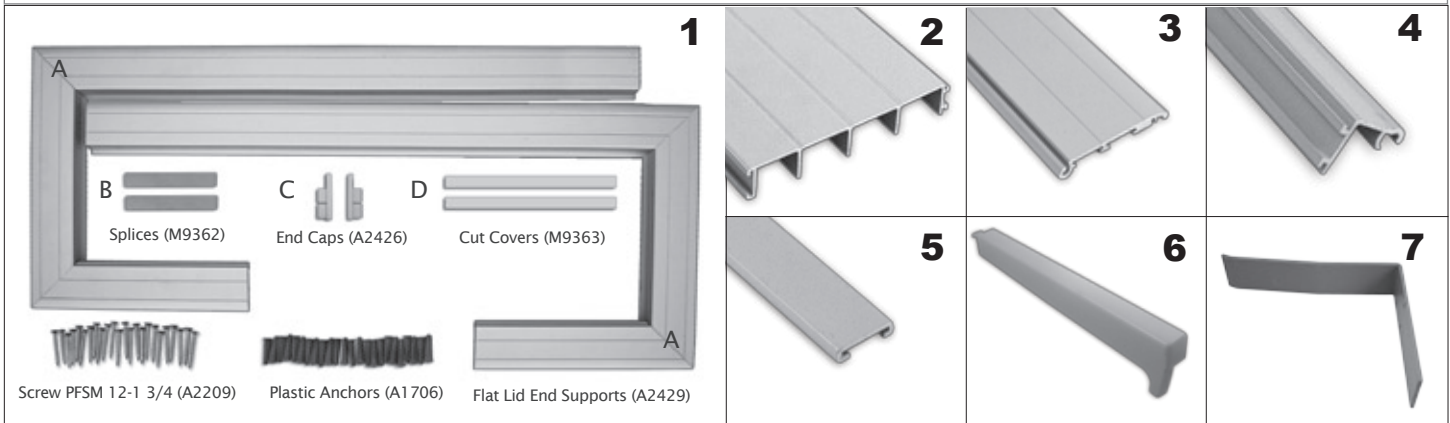

Diagram above and Images below not to scale



Assembly	Part#	Qty	Description
A2432	Lid kit - Flat lid 309 for TG 14 in box (Includes Lid Brackets)		
1.	A2454	1	Flat Lid 309 End Support Assembly SET and system hardware kit
2.	X0048	2	Lid Panel Flush (1 in by 6 in) 24 ft length
3.	X0939	1	Flat Lid 309 Hinge, 22 ft length
4.	X0940	1	Flat Lid 309 Lid Panel to Hinge Attachment, 24 ft
5.	X0053	1	Metal Box C-Cap
6.	A2425	1	Flat Lid 309 Wedge SET
7.	A2430	1	Lid Bracket RTG (97 degree) 12 In SET of 2.



1 Attach the 97 degree angled brackets (A2430) to the back wall of the housing 1 in below the top of deck.



2 Set the lid end support (A2429) in the ends of the housing in order to get an accurate measurement for the lid panels.

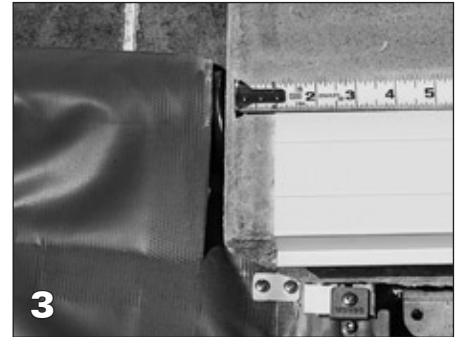

3 Mark and cut the front side of the lid end supports leaving at least 1 in of flat surface between the coping edge and the lid end support.



4 Insert the end caps (A2426) to the lid end supports.



5 Measure and cut the lid panels (X0048), C-cap (X0053), and hinge attachment (X0940) approximately 1 1/4 in shorter than the actual width to the inside of the lid end supports. This allows space for the cut cover and lid wedges to attach to the ends of the lid panels to cover any cuts.

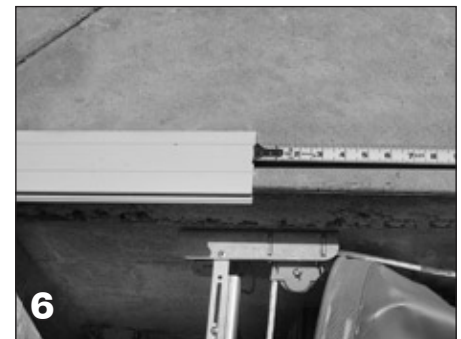

6 Measure and cut the lid hinge (X0939). Measure from one lid end support to the other.



7 Slide the lid panels (X0048) and C-cap (X0053) together.



8 Slide the hinge attachment (X0940) and lid hinge onto the lid.



9 Use a rubber mallet to tap on the lid wedges on both sides of the main lid section.



10
The hinge attachment (X0940) should be flush with the end of the lid and the lid hinge is offset from the end.



11
Measure and cut motor and non-motor lid ends to fit. Attach the cut cover pieces (M9363) to both sides of the motor and non-motor end lid.

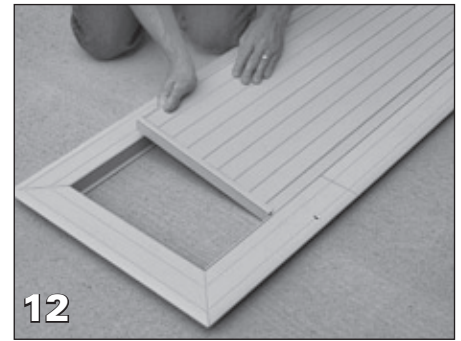

12
Slide the motor end and non-motor lid sections onto the lid end support.



13
Insert the lid hinge splices (M9362) between each section of the lid end support and the hinge and slide them tightly together.

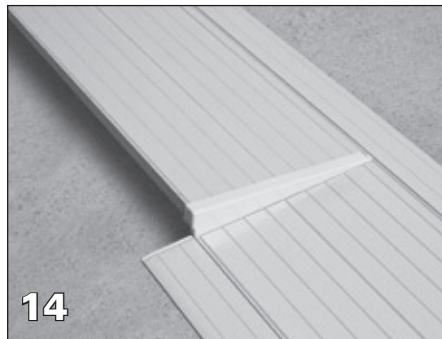

14
Slide the center section through the hinge into the position shown.

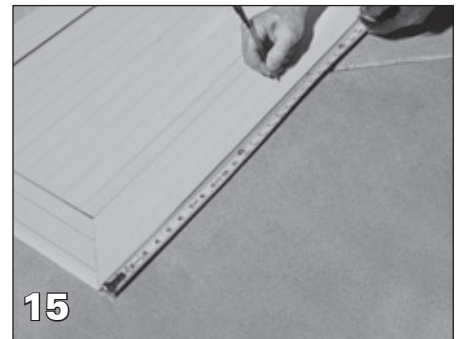

15
With the lid completely assembled, set it over the housing. Next, mark and drill holes through the lid hinge approximately every 18 inches. Drill the holes into the deck through the holes in the lid hinge.



16
Remove the lid and hammer the plastic anchors (A1706) into the holes.

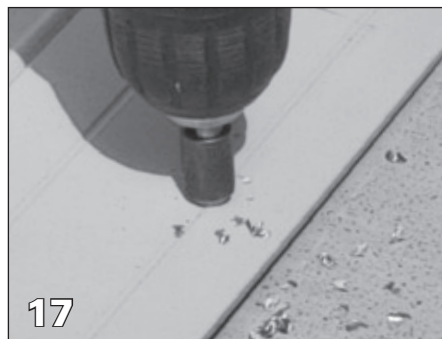

17
Countersink the drill holes in the hinge.

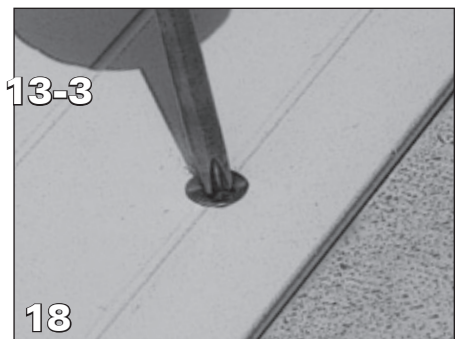

18
Place assembled lid over the housing and screw it into place using the 1 x 1 3/4 stainless steel screws (A2209).

